

# 48x40 Light Duty

## Export Pallet

| SPECIFICATIONS                          |                |
|---|----------------|
| Item #                                  | 104815         |
| Dimensions                              | 48" x 40" x 6" |
| Weight                                  | 25 lbs         |
| Static (Floor) Capacity                 | 15,200 lbs     |
| Dynamic (Forklift) Capacity             | 3,800 lbs      |
| Racking (Edge) Capacity <sup>(1)</sup>  | 1,100 lbs      |
| # In A Stack (LTL / FTL) <sup>(2)</sup> | 16 / 18        |
| Truckload Qty                           | 540            |
| Material                                | HDPE/PP        |



Meets GMA standards with full 6 runner bottom deck design.

<sup>(1)</sup>Rated racking capacity is for standard edge racking where pallet is only supported by two points at the edges. Racking capacity for other types of racks will be different. Nominal specifications subject to change without notice. Product performance characteristics vary with application.

<sup>(2)</sup># In A Stack: LTL (Less Than Truckload) = is based upon 96" height of standard LTL carriers. FTL (Full Truckload) = is based upon height of standard 53' trailers.

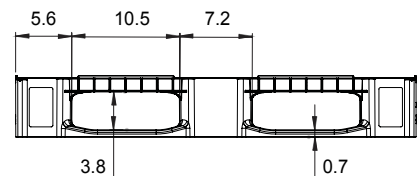
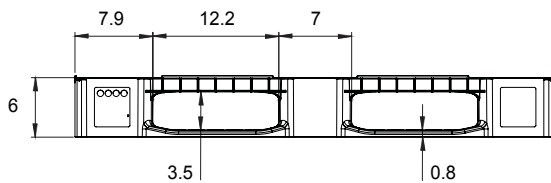

Phone: (800) 827-2474

Website: [www.tranpak.com](http://www.tranpak.com)

Address: 1209 Victory Ln. Madera, CA 93637